

Manual Rakit MT-562

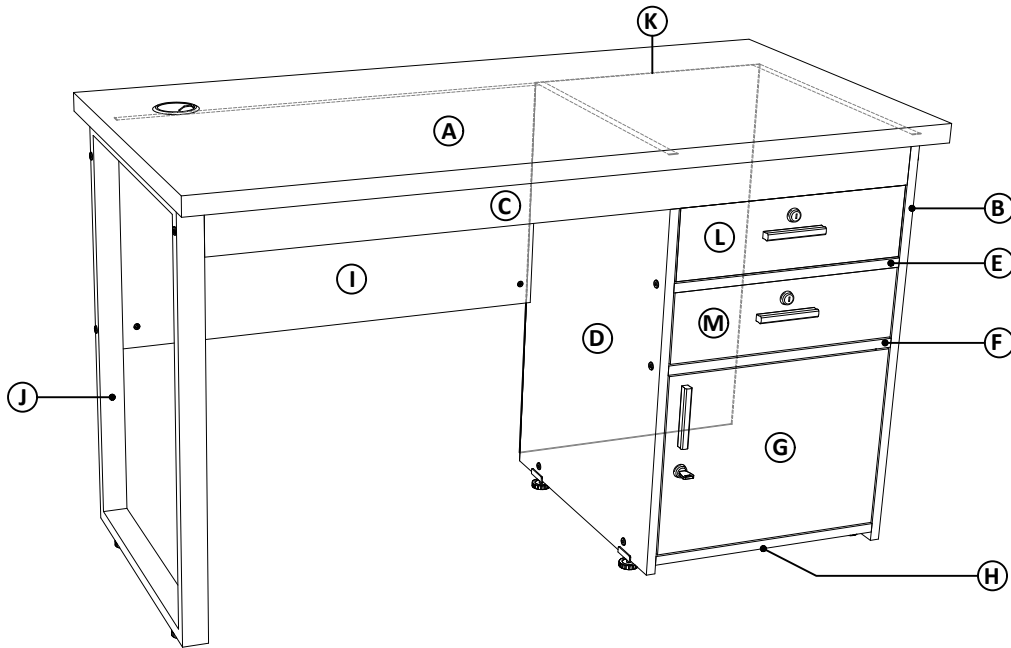

Aksesoris

No	Picture	Qty	Checklist
1	Baut DU 6X36	8 pcs	
2	Minifix 15	8 pcs	
3	JCBC M6X30	2 pcs	
4	JCBC M6X40	11 pcs	
5	JCBC M6X70	3 pcs	
6	JRN M6	14 pcs	
7	Baut FH 6X1/2	38 pcs	
8	Duplo	2 pcs	
9	Adjuster	6 pcs	
10	Handle T	3 pcs	
11	Baut Handle	6 pcs	
12	Kunci	3 pcs	
13	L Grendel	2 pcs	
14	Kunci L	1 pcs	
15	Lubang kabel	1 pcs	
16	Paku triplek	20 pcs	
17	Olimpik 6x1 1/2	4 pcs	
18	Rel 300 mm	2 set	
19	Dowel 8x25	5 pcs	
20	Tatakan adjuster	4 pcs	

Komponen Panel

Code	Name	Checklist
A	TOP	
B	KA KN	
C	SDG DPN	
D	KA TGH	
E	SKT ATS	
F	SKT TGH	
G	PNT	
H	ALAS	
I	SDG BLK	
J	KA BESI	
K	TRIPLEK BLK	
L	LACI DPN ATS	
M	LACI DPN BWH	
N	LACI KR (2x)	
O	LACI KN (2x)	
P	LACI BLK (2x)	
Q	TRIPLEK LACI (2x)	

*Mohon lakukan pengecekan sebelum merakit

1

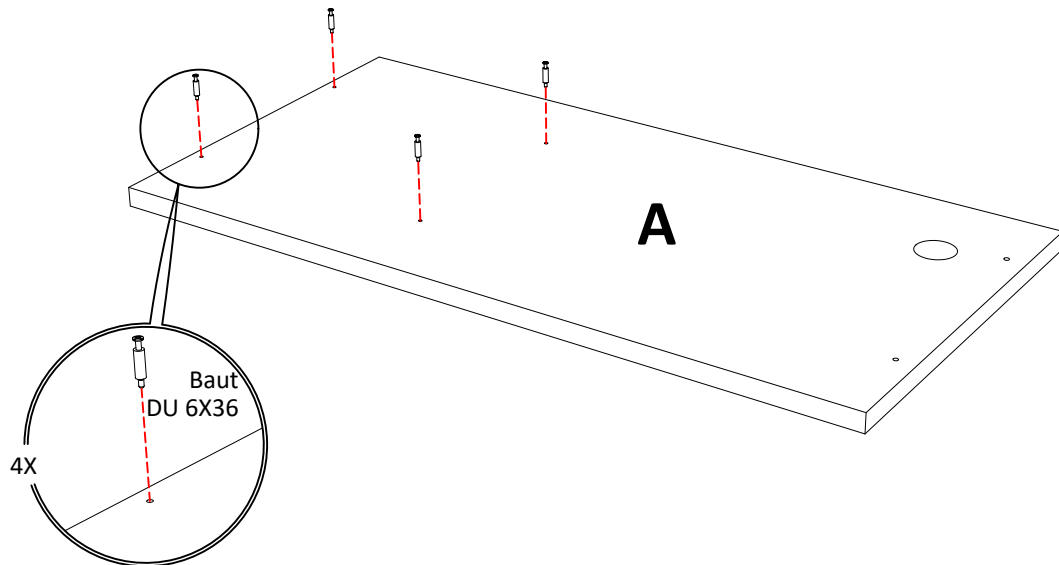

2

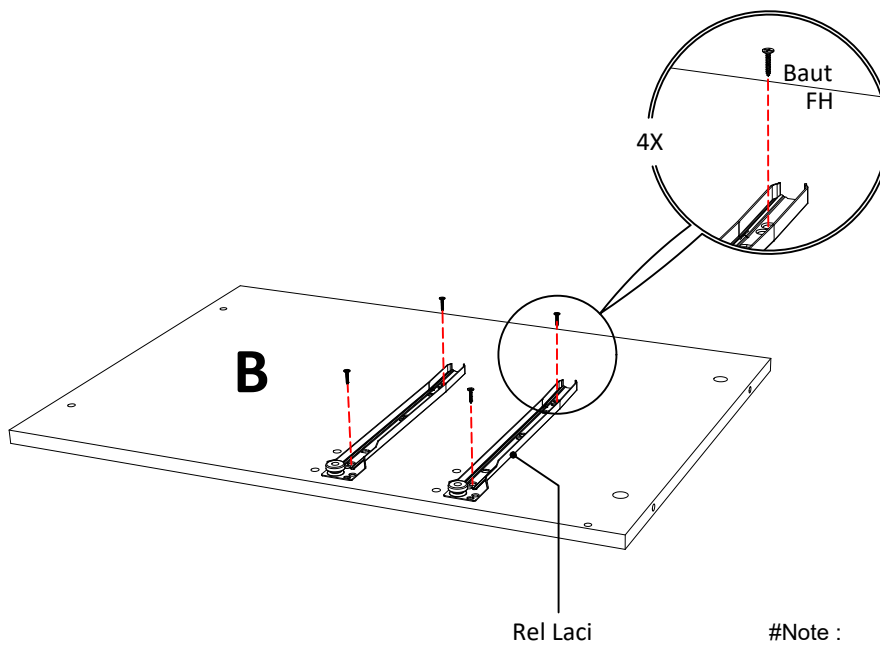

#Note :
Pemasangan baut FH ke Rel bisa menggunakan titik lubang yang telah disiapkan di papan B . (Optional)

3

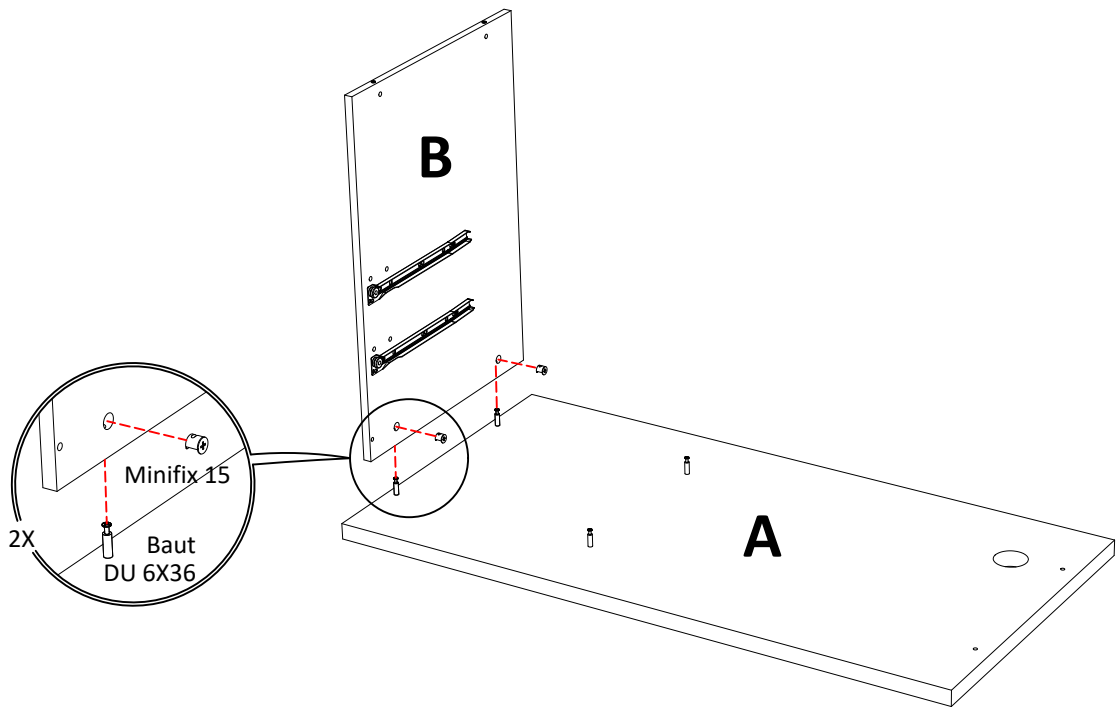

#Note :
Pastikan Tanda Panah MiniFix
mengarah ke luar / Baut DU

4

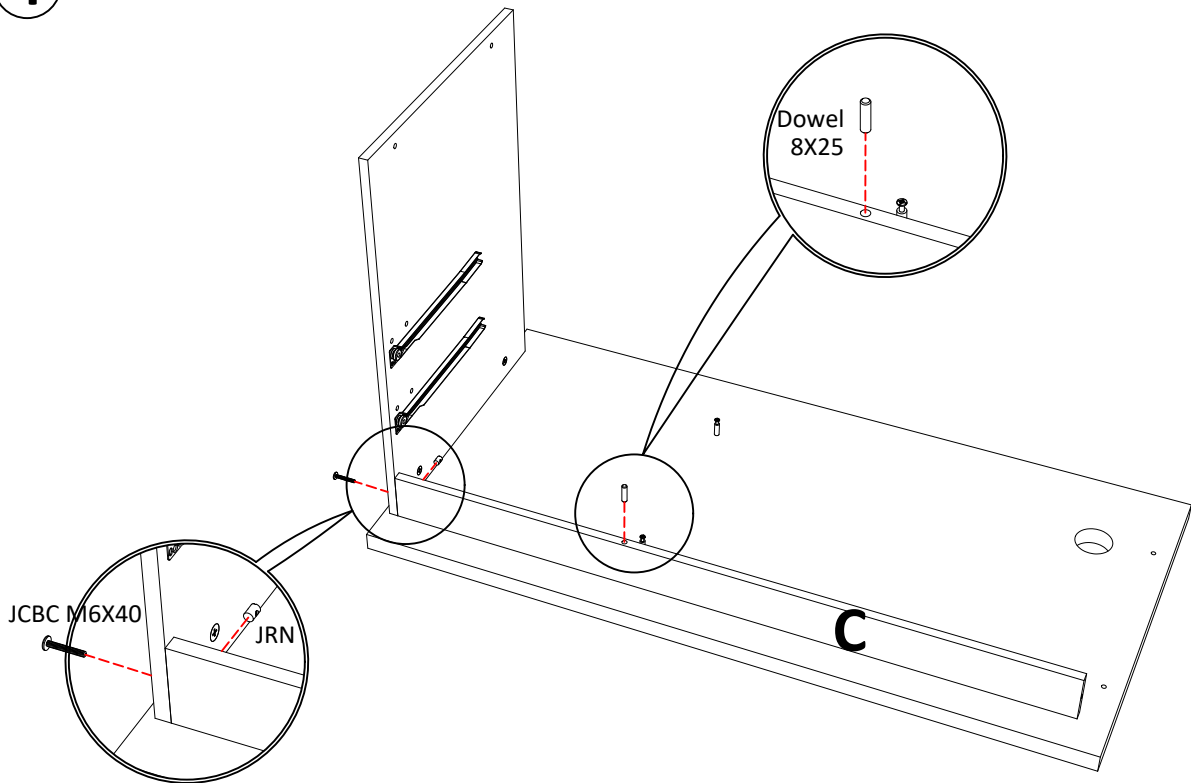

5

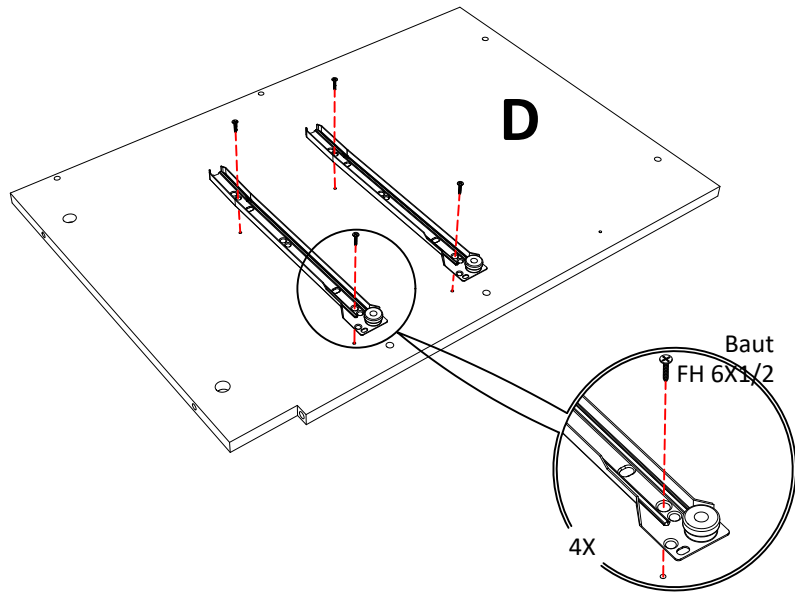

#Note :
Pemasangan baut FH ke Rel bisa menggunakan titik lubang yang telah disiapkan di papan D (Optional)

6

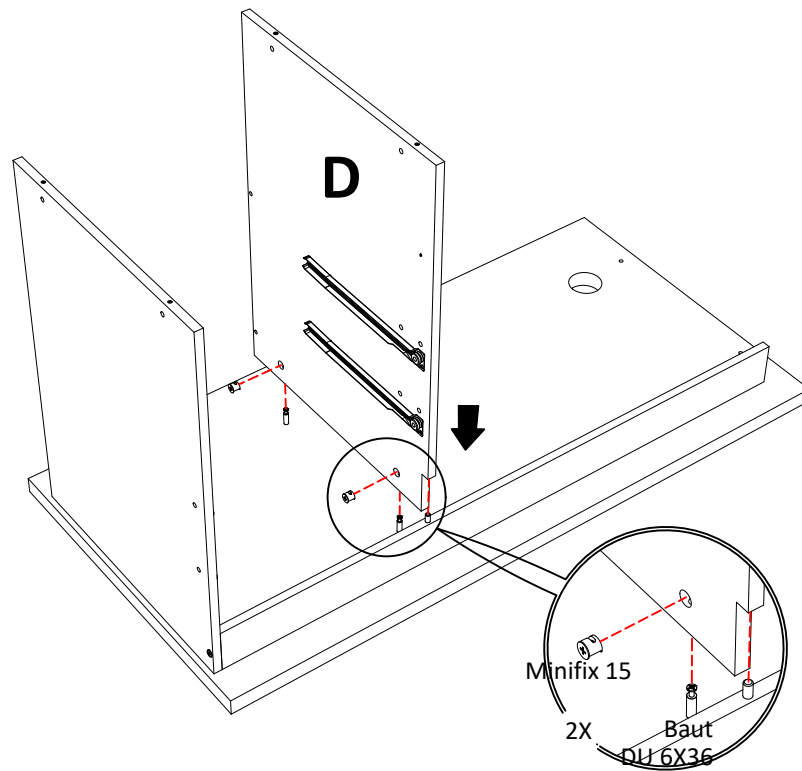

7

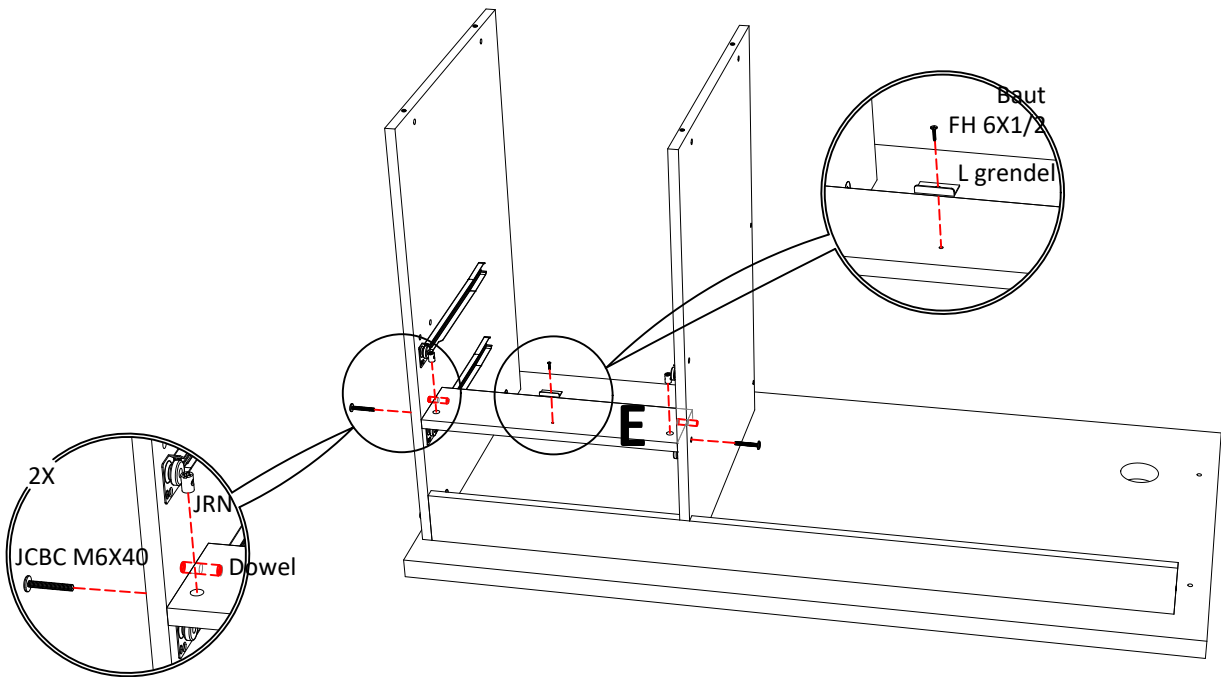

8

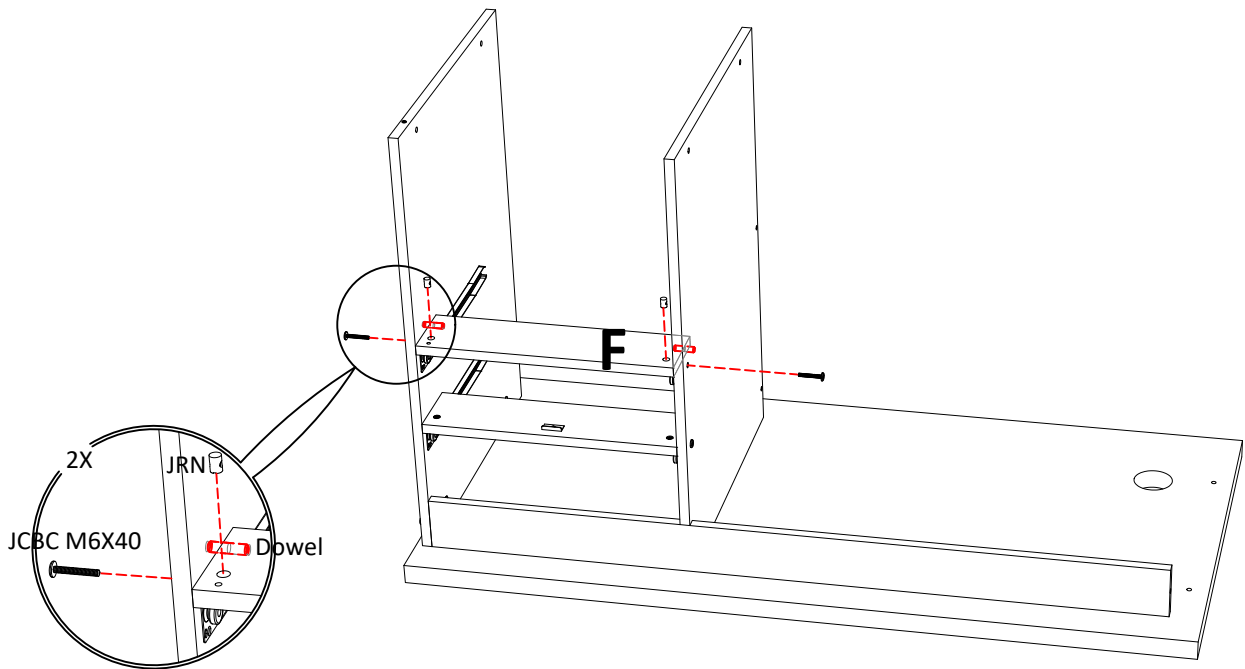

9

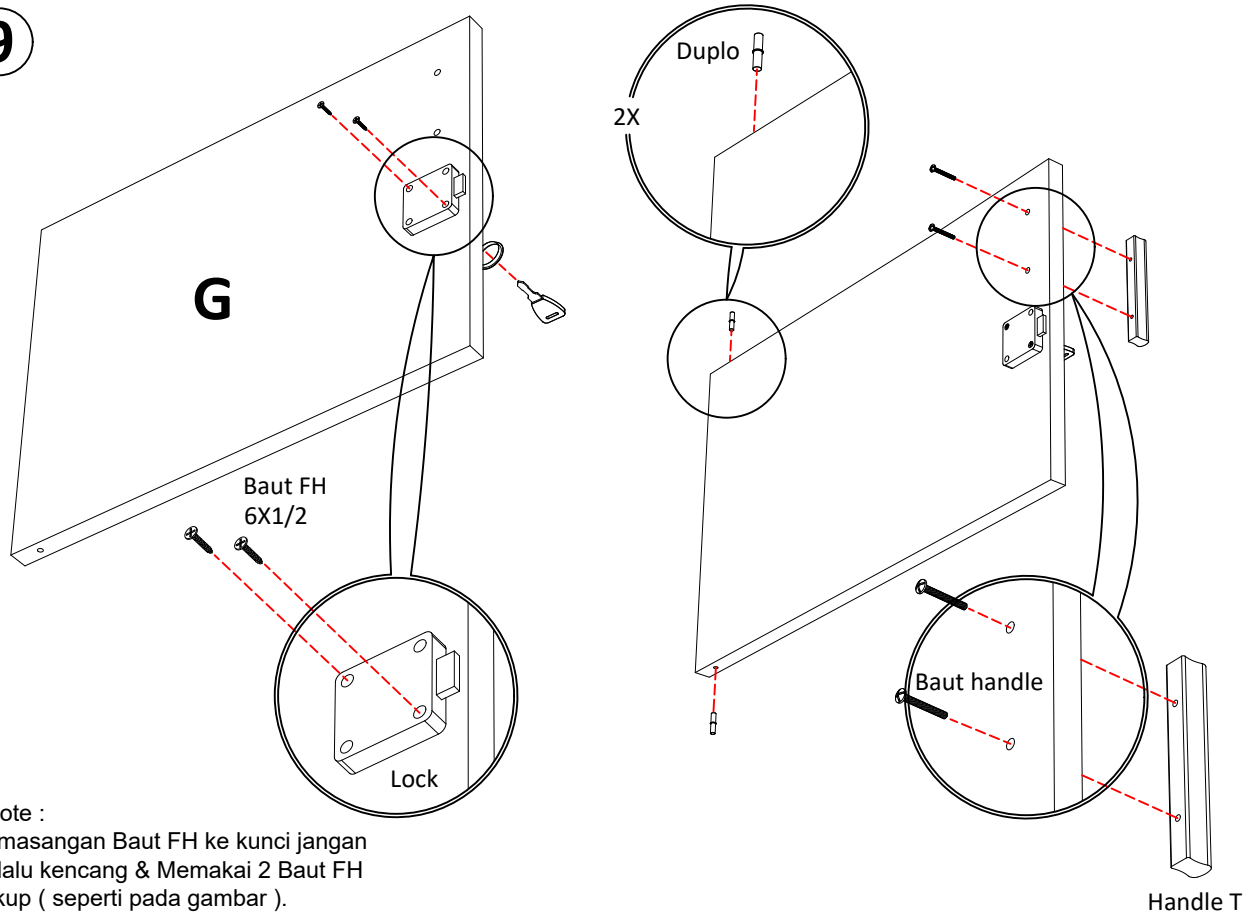

#Note :
Pemasangan Baut FH ke kunci jangan
terlalu kencang & Memakai 2 Baut FH
cukup (seperti pada gambar).

10

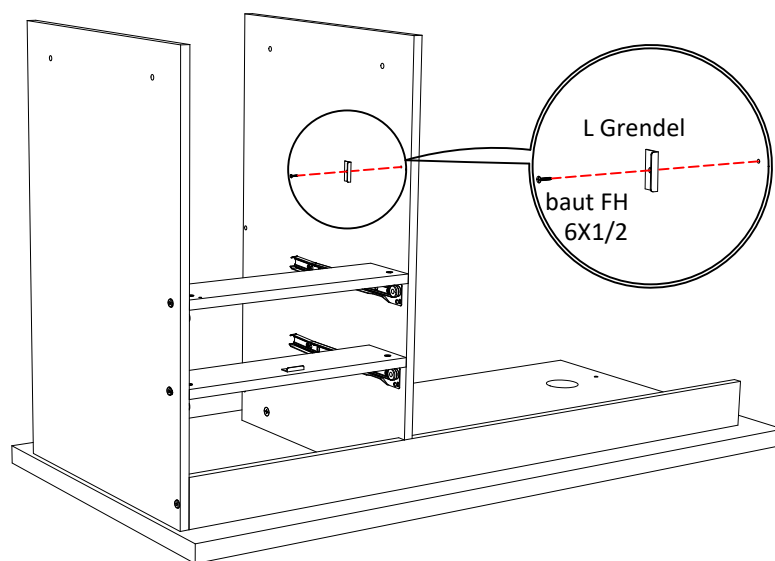

11

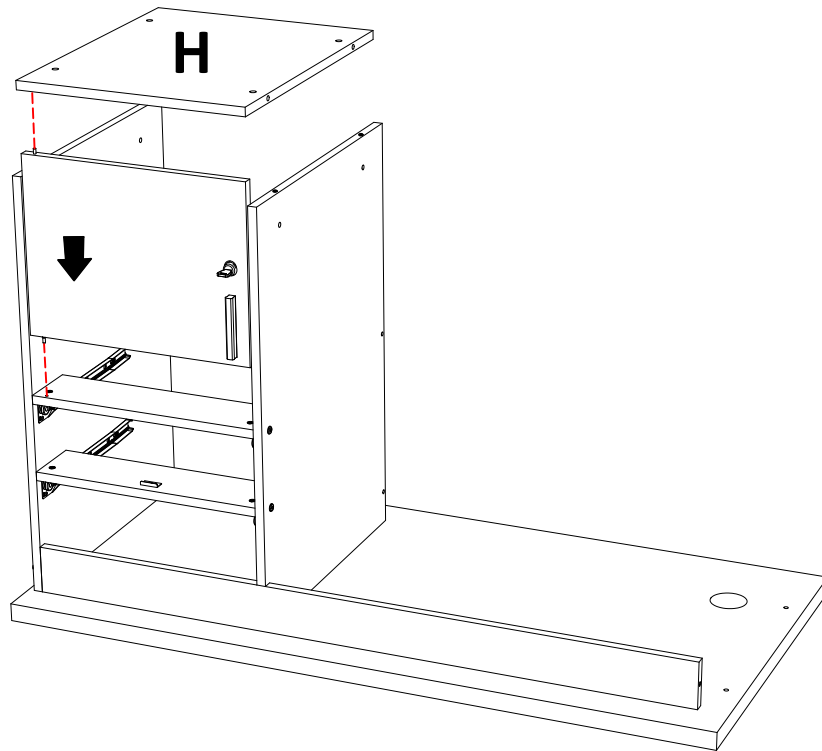

12

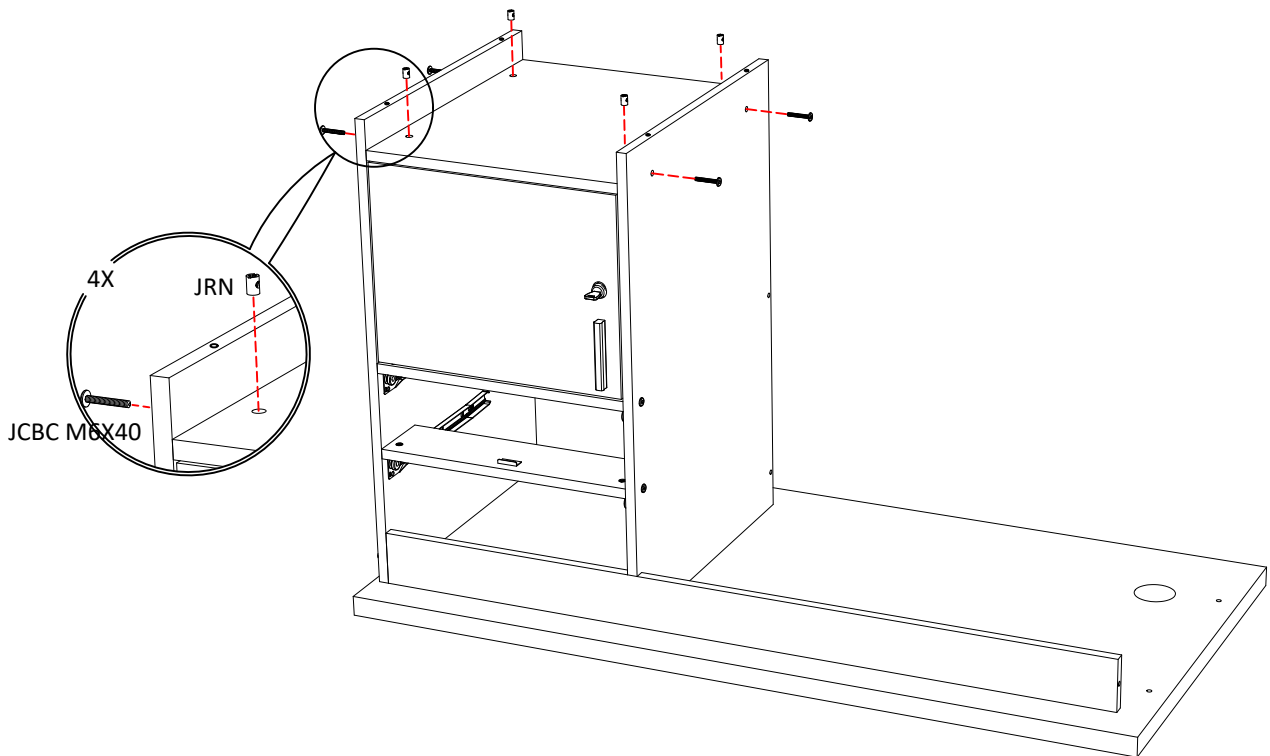

13

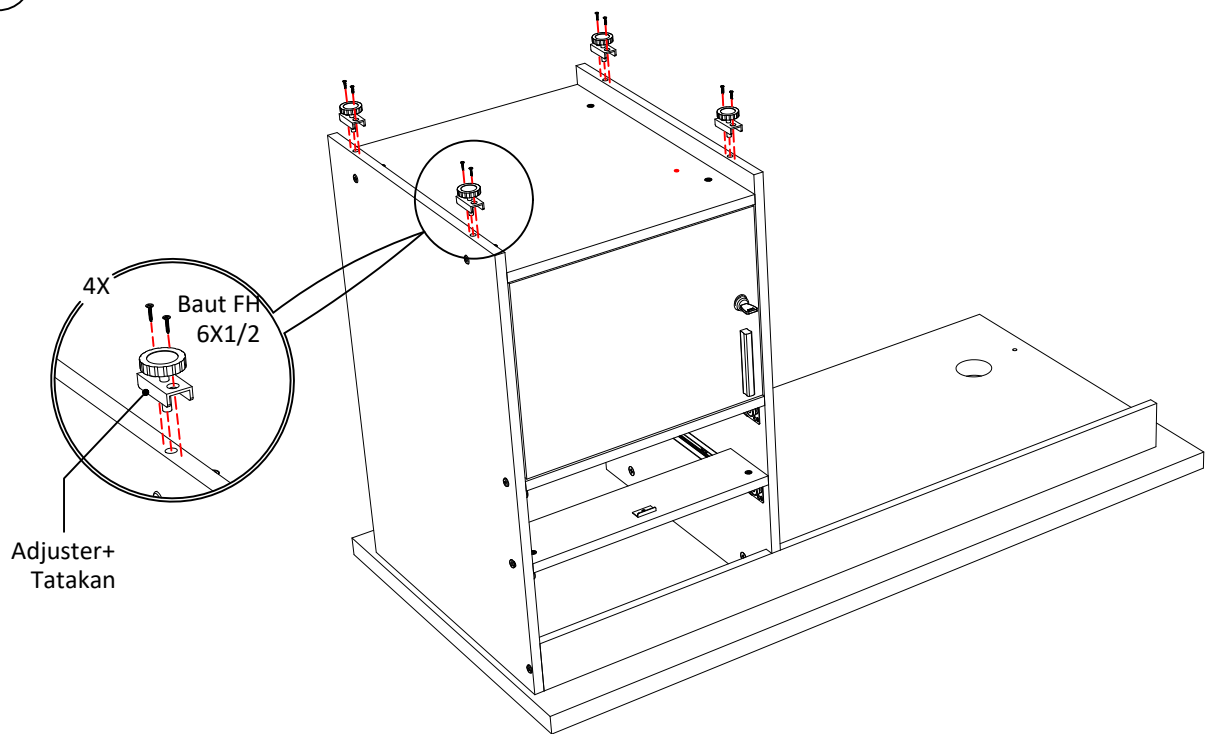

14

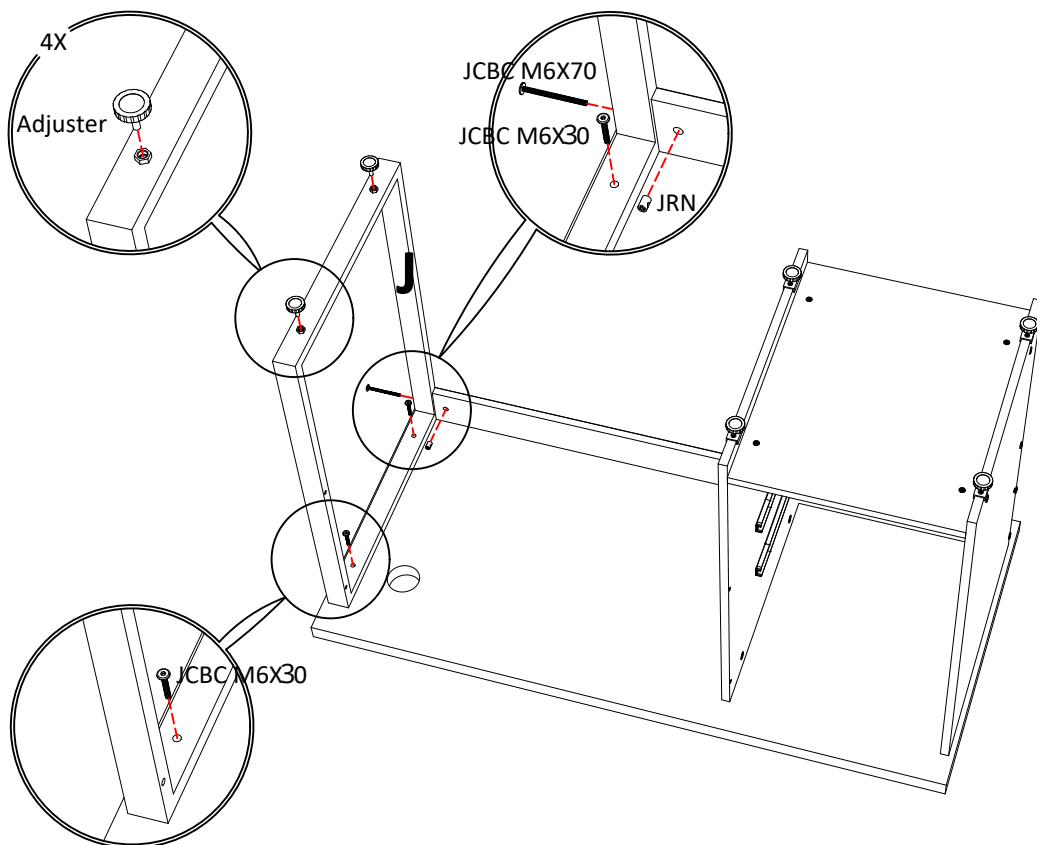

15

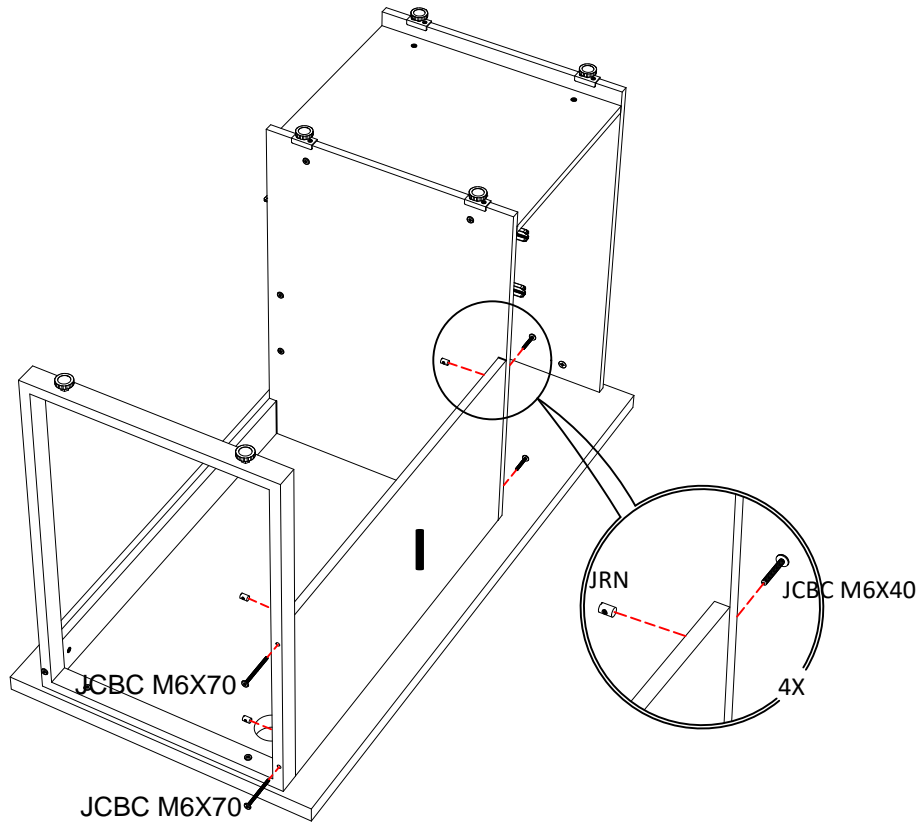

16

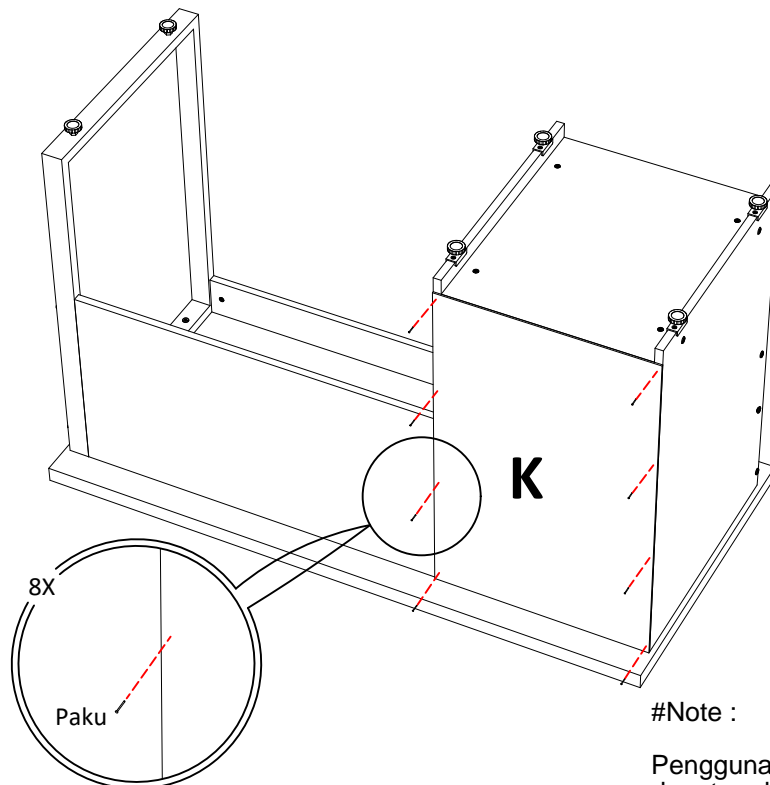

#Note :

Penggunaan jumlah paku dapat anda sesuaikan dengan kebutuhan instalasi triplek

17

L & M

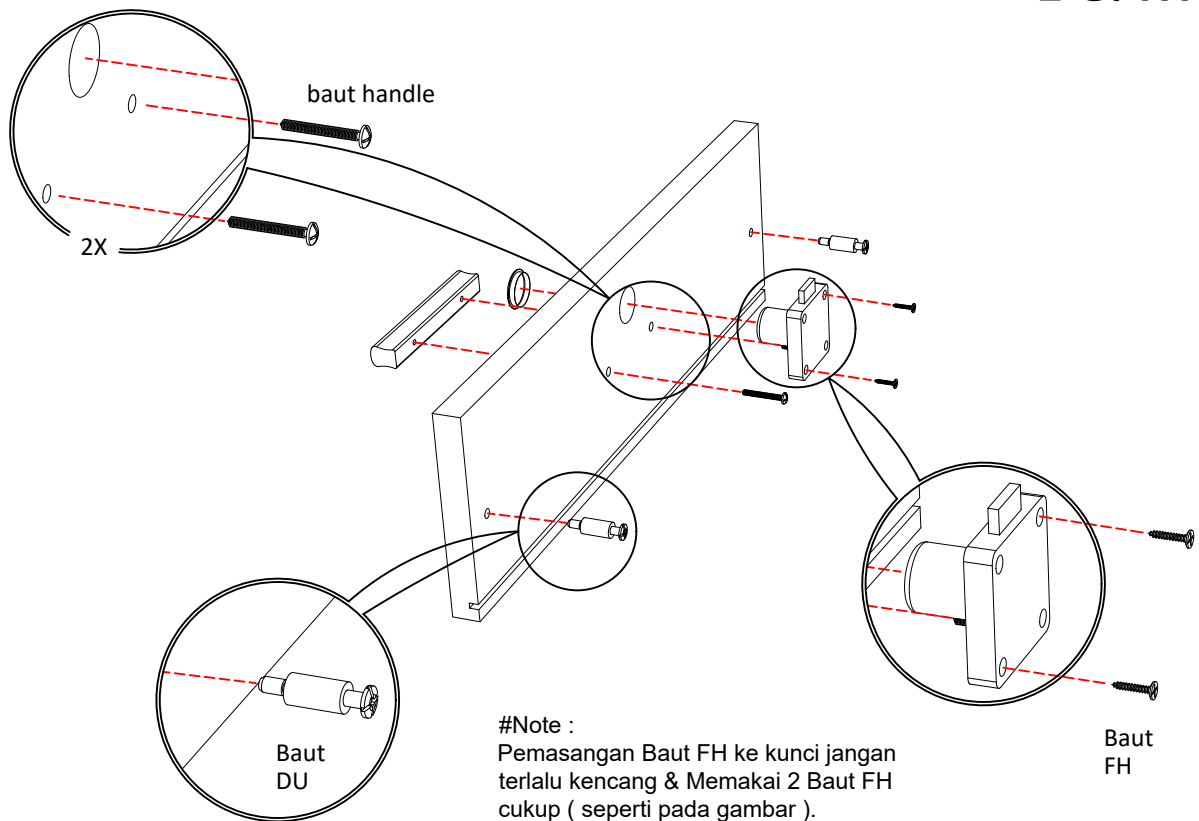

18

L & M

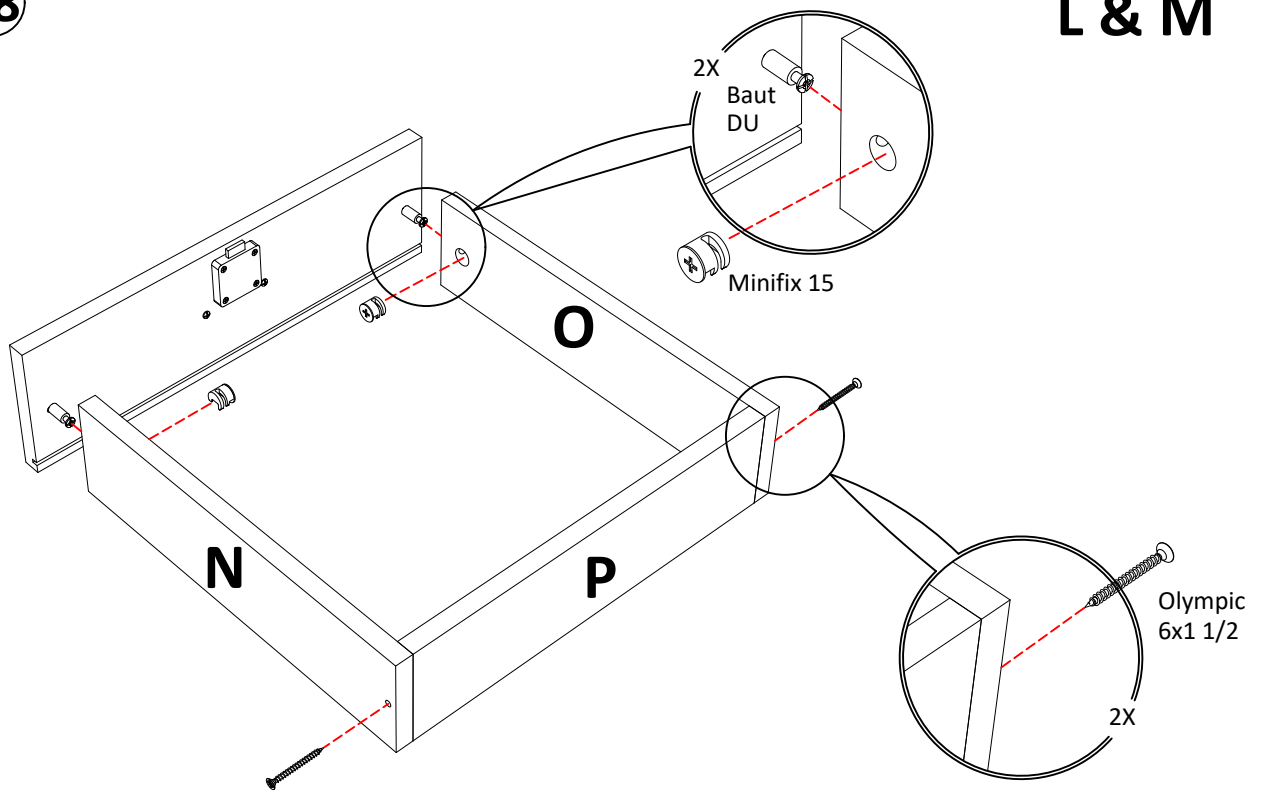

19

L & M

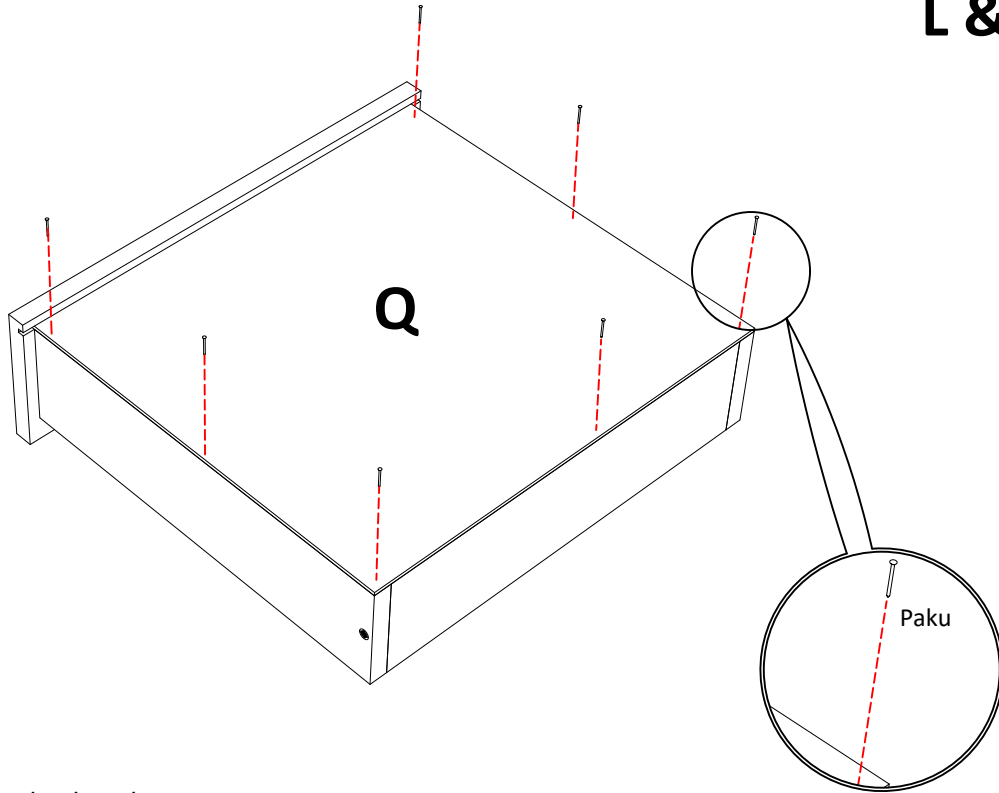

#Note :

Penggunaan jumla paku
dapat anda sesuaikan dengan
kebutuhan instalasi triplek

20

L & M

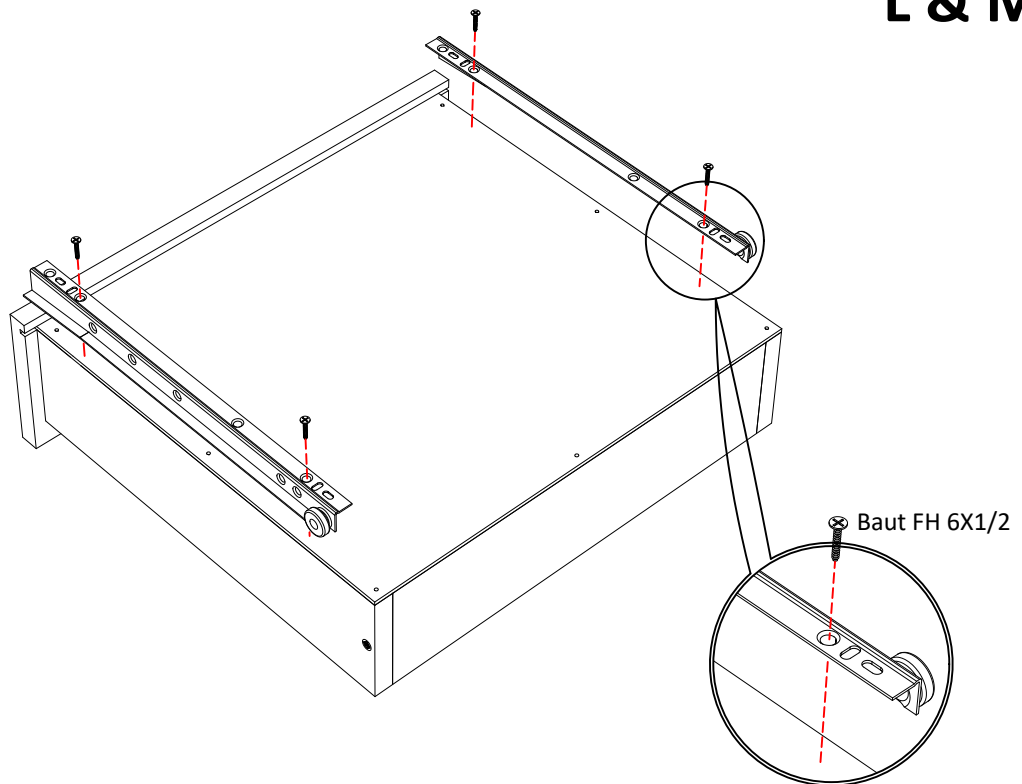

21

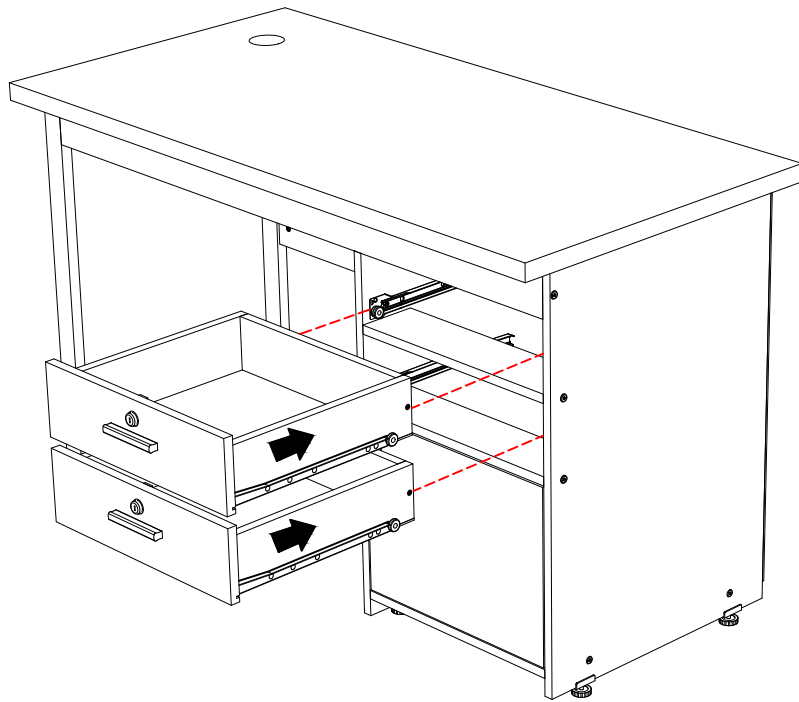

22

